



Table of contents

Page 2	Aquareva underwater lights - Technical data
Page 3	Masonry / Liner
Page 4	Concrete
Page 6	Panel / Liner
Page 7	Polyester shell
Page 8	Wooden pools, Connection, Aquareva Color, Underwater light face trims.

Technical data:

Made in France, Aquareva underwater lights embody the latest in technological innovation to guarantee reliability and quality.

The Aquareva range of underwater lights can be divided into five categories, each dedicated to a particular type of pool; liner pools, traditional concrete pools, panel pools, polyester shell pools and pools with a wooden structure.

Common features:

Made of pool grade, anti-UV treated ABS,

Self-adhesive elastomer seals,

Screws made entirely of stainless steel, identical for each part,

Protective work site covers,

Available in a range of colours,

Made in France.

Technical data

Anti-UV treated ABS.

Anti-UV treated, pool chemical resistant ABS gives Aquareva underwater lights a bright finish that doesn't fade over time under normal conditions of use.

The bodies of the liner and concrete versions of each Aquareva underwater light model are identical.

In the event of leaks in a traditional pool fitted with an Aquareva underwater light, a reinforced membrane or liner can be easily fitted. The "concrete" underwater light is transformed into a "liner" underwater light by the simple addition of the necessary flange, seals and screws.

Thin walls.

Aquareva PL/PB-84 underwater lights are fitted with a face ring that allows for their installation on pre-fabricated pool structures. The flange is spot faced to allow flush mounting of the underwater light on a thin wall pool.

Fixing the guts pack.

PL/PB-84V: The guts pack is held firmly in place with 2 screws. It can't be accidentally pulled out of the niche: bathers using the underwater light as a toe hold to leave the pool, children playing, etc.

PL/PB-84C: The underwater light guts pack is clipped into place.

45° cable outlet.

The cable outlet situated behind the underwater light is at a 45° angle to allow the cable to be run vertically or horizontally. The protective duct covering the power cable connects simply to the deck box, there are no elbows to impede the passage of the electric cable. Leaktightness at the point where the cable enters the niche is ensured by a cable gland.

Corrugated duct.

The union on the corrugated duct moves to allow the duct to be cut to the exact length separating the niche from the deck box. This prevents the formation of bends that could impede passage of the cable through the duct. The corrugated duct meets ICT requirements so it won't be compressed or crushed by the weight of the back fill or concrete. A special union, screwed to the end of the duct ensures perfect leaktightness where the duct meets the deck box.

Electrical cable.

The underwater light electrical cable; HO7RNF - RO2V, diameter 4 mm², Cu, 2.20 metres long, was purpose designed and manufactured for use in a pool environment

to ensure compliance with the standards in effect. It withstands exposure to chlorinated products and is not deteriorated over time.

IP-X8.

The underwater lights meet the stringent stipulations laid out in the electrical insulation standard NF C-15-100 governing use in a pool environment. They are also approved by the SASO (Saudi Arabian Standard Organization), for sale in Saudi Arabia.

Work site protective covers.

The self-adhesive work site covers delivered with each Aquareva underwater light are intended to be fitted over the underwater light to protect the underwater light niche and the screw housings and stop them from being damaged or filled in with cement or concrete while the pool is being built.

Lamp.

The "General Electric" PAR-56, 300 Watts/12 Volts lamp equipping Aquareva underwater lights is unanimously considered to be the best available on the market, in terms of performance data and service life.

Lamp leaktightness.

The lamp leaktightness in the guts pack is ensured by a lip seal capable of compensating for any irregularities in the lamp wall. This eliminates the risk of leaks and damage to the lamp.

Single type of screw.

All the screws required to fit an Aquareva underwater light are made of 18/10 stainless steel and are identical. Therefore it is easy to keep a supply in stock for future requirements.

Self-adhesive seals.

Liner type Aquareva pool fittings come with 2 self-adhesive elastomer seals that are easy to install and resistant to pool chemicals.



Masonry / Liner



PL-84V-M

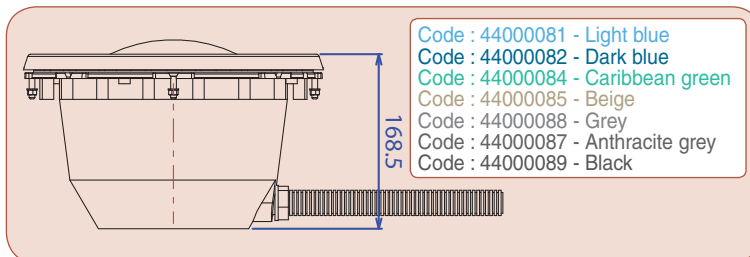

Code : 44000000 : 300W-12V, screwed.



PL-07V-M

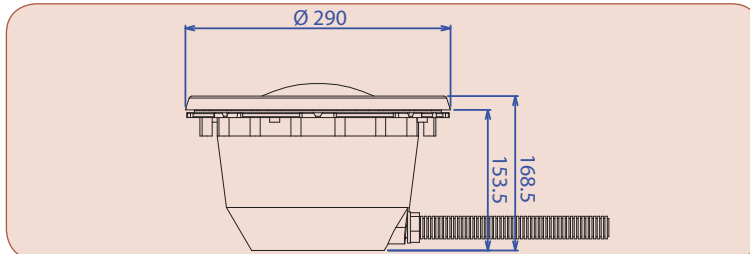

Code : 44006000 : White LEDs, 25W-12V, screwed.

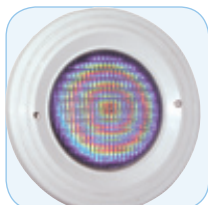

PL-06V-M

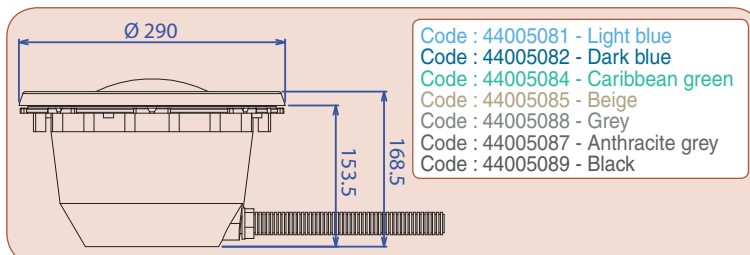

Code : 44005000 : 252 Colour LEDs, 12V, screwed.



PL-84C-M

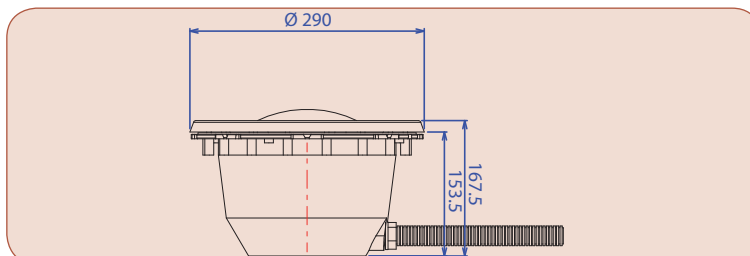

Code : 44020000 : 300W - 12V, clipped.



PL-96B-M

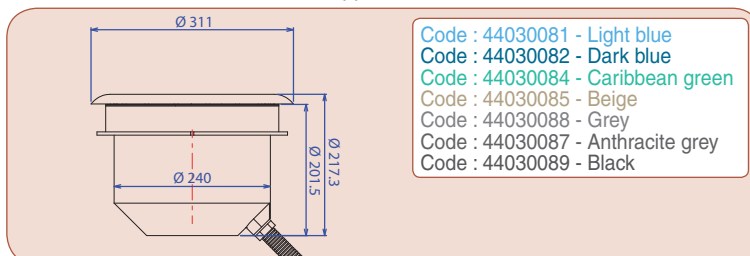

Code : 44030000 : Directional, 300W - 12V.



PL-06B-M

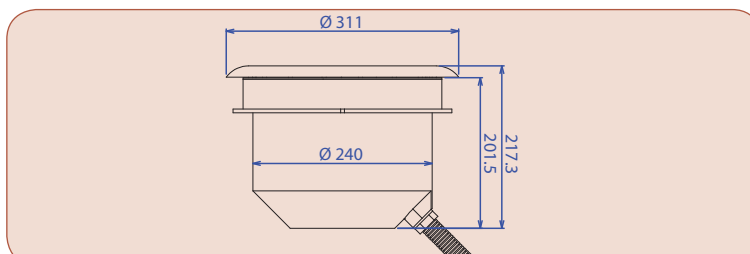

Code : 44035000 : Directional, 252 Colour LEDs, 12V.



PH-04

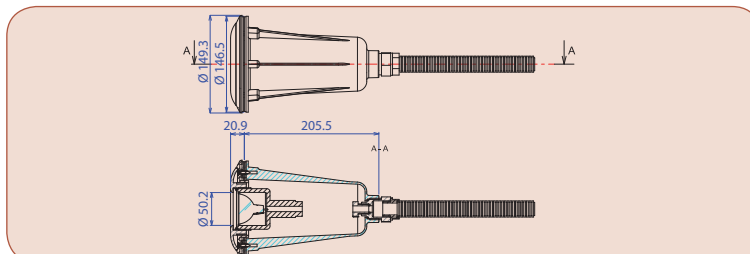

Code : 44050000 : Halogen 50W - 12V, with niche and duct.

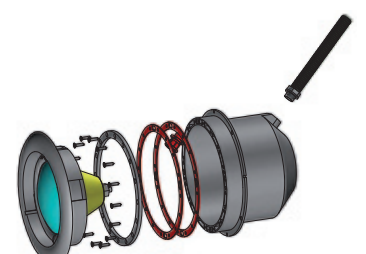
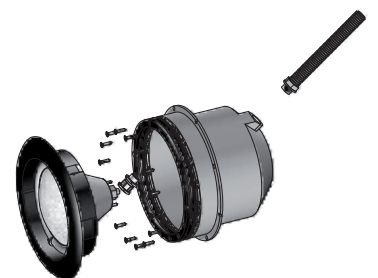
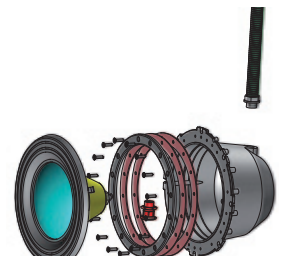
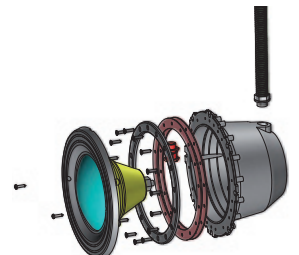
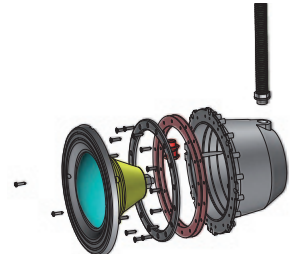
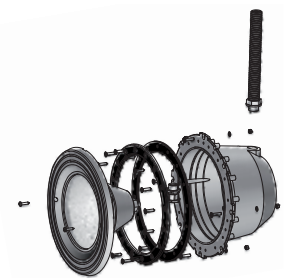

Concrete



PB-84V

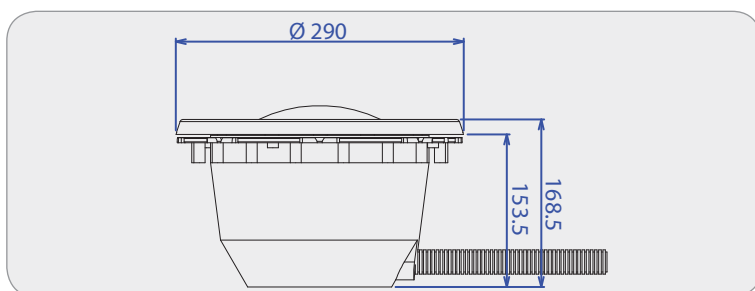

Code : 44600000 : 300W-12V, screwed.

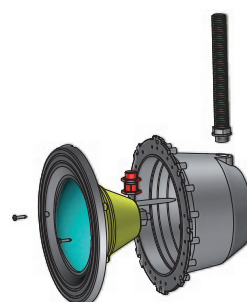

PB-84V3

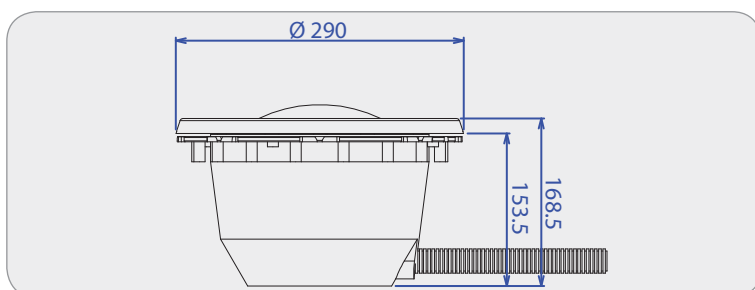

Code : 44610000 : 300W-12V, screwed, with 3 m cable.

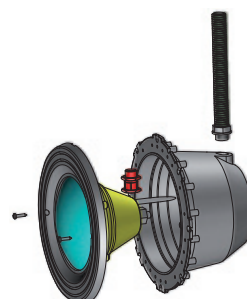

PB-07V-M

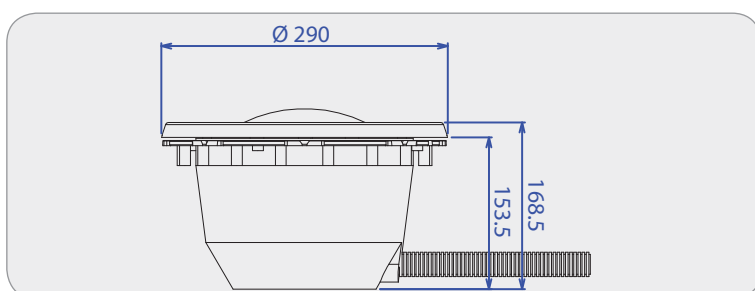

Code : 44610000 : White LEDs, 25W-12V, screwed.

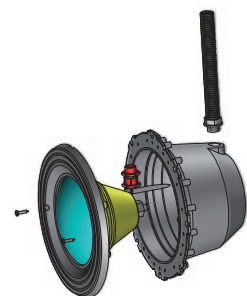

PB-06V

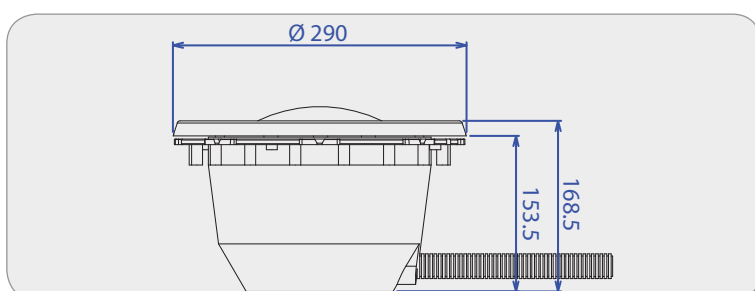

Code : 44605000 : 252 Colour LEDs, 12V, screwed.

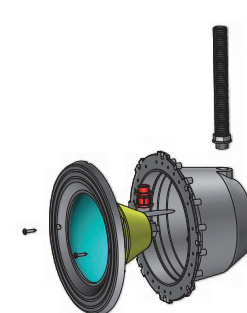

PB-84C

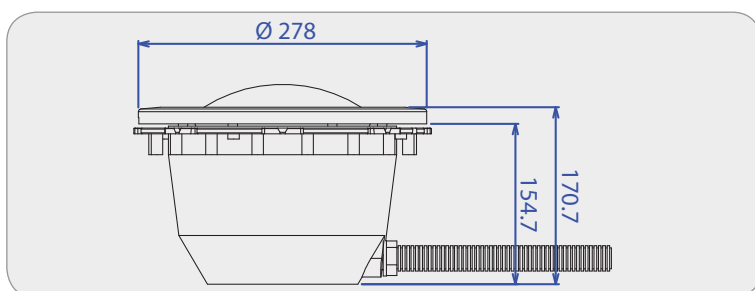

Code : 44620000 : 300W-12V, clipped.

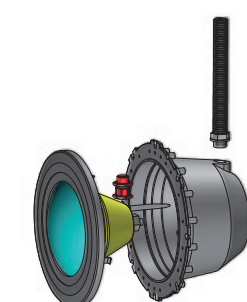

Concrete



PB-96B

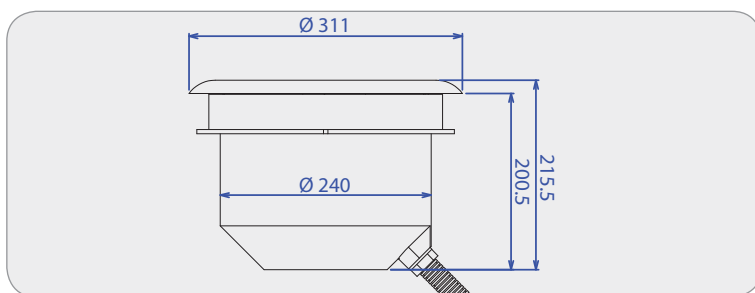

Code : 44630000 : Directional, 300W-12V.

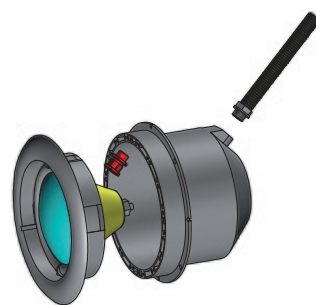

PB-96B3

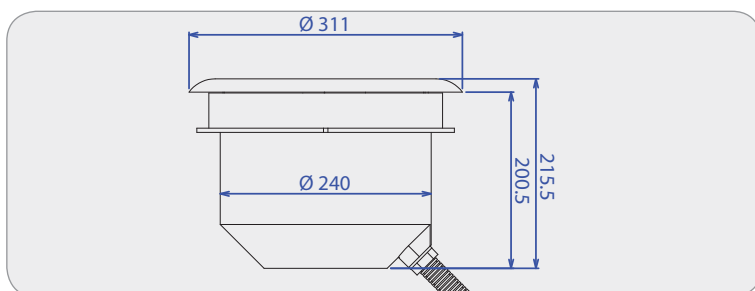

Code : 44630000 : Directional, 300W-12V, with 3 m cable.



PB-06B

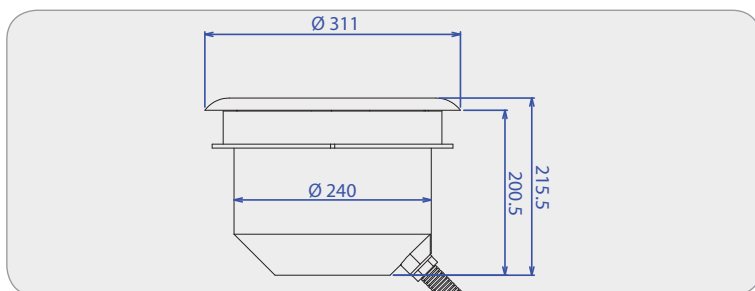

Code : 44635000 - 252 Colour LEDs, directional, 12V.



PH-04

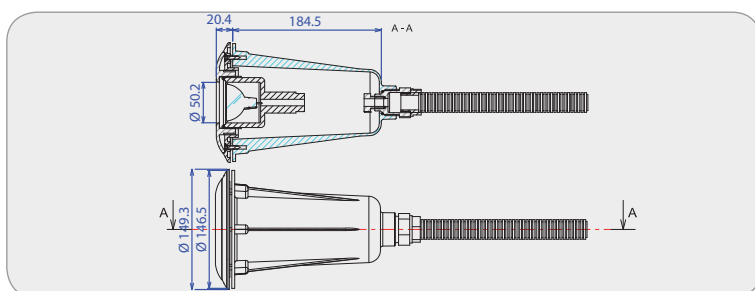

Code : 44050000 - Halogen 50W-12V, with niche and duct.

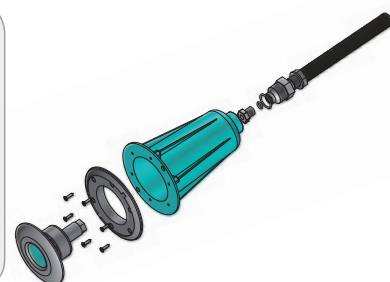

PH-05-100

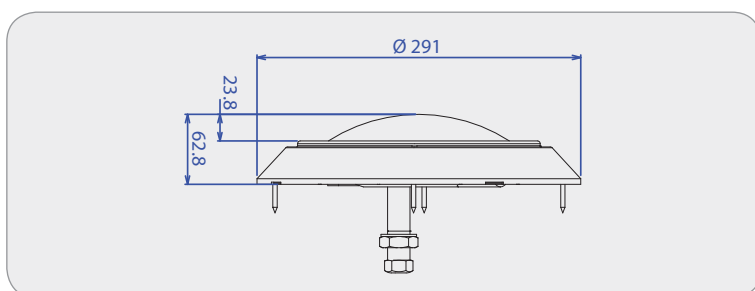

Code : 44650000 : Halogen extra flat, 100W white PBC.

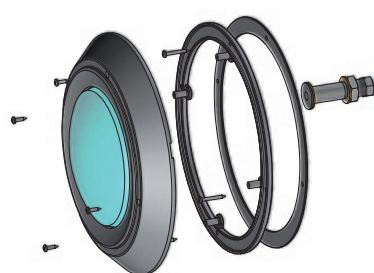



Panel / Liner



PL-84V-P

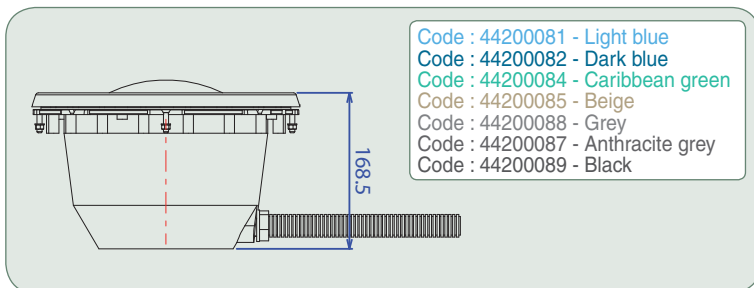

Code : 44200000 : 300W-12V, screwed.

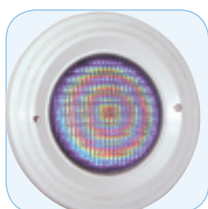
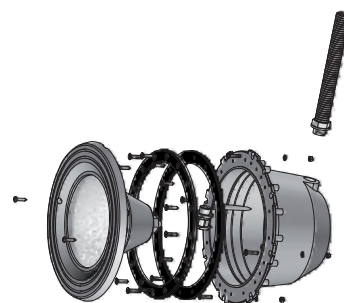

PL-06V-P

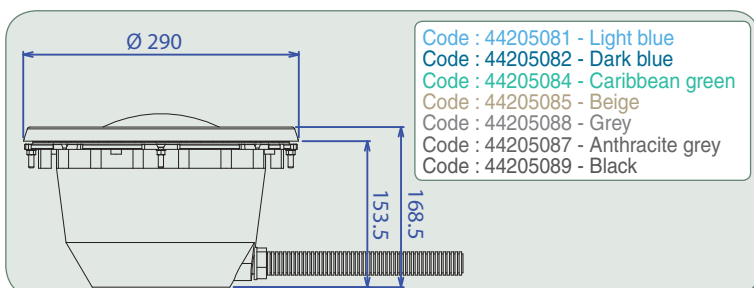

Code : 44205000 : 252 Colour LEDs, 12V, screwed.

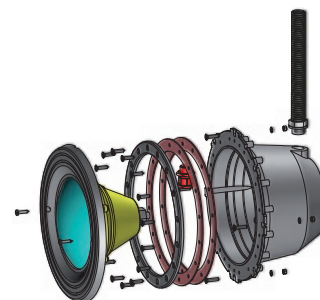

PL-84C-P

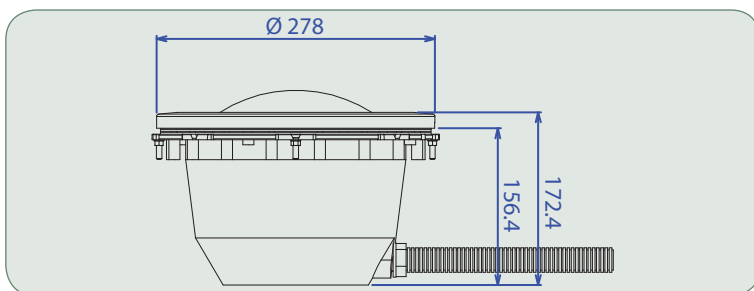

Code : 44220000 : 300W-12V, clipped.

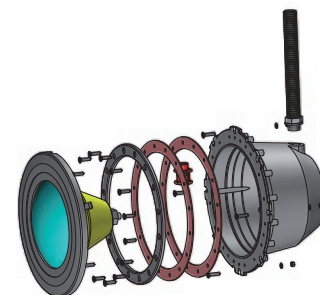

PL-96B-P

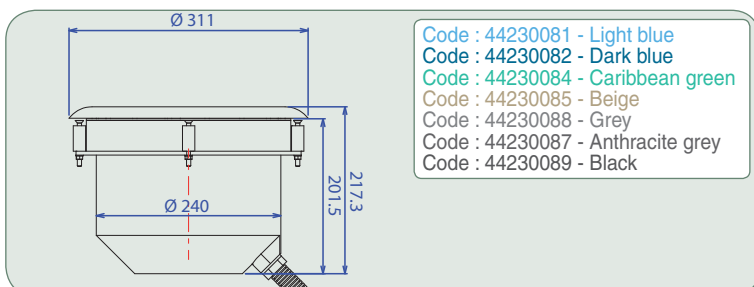

Code : 44230000 : Directional, 300W-12V.

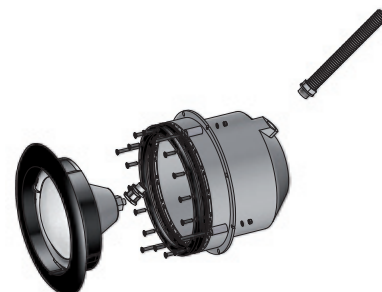

PL-06B-P

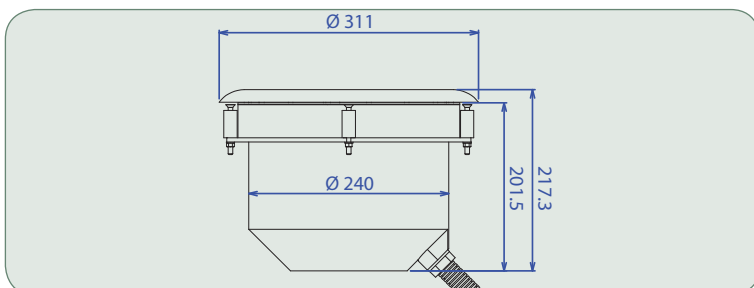

Code : 44235000 : 252 Colour LEDs, directional, 12V.

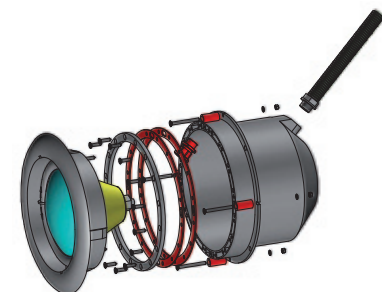

PH-05-100

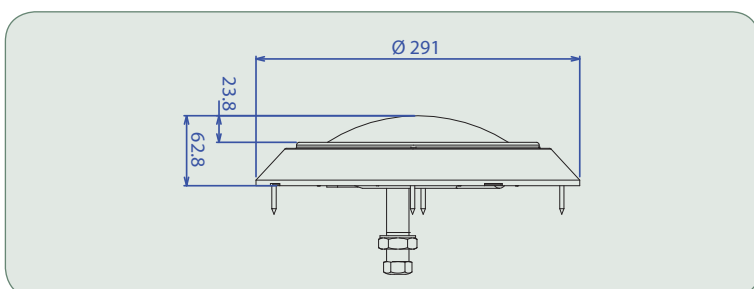

Code : 44650000 - Halogen extra flat, 100W white PBC.



Polyester shell



PL-84V-C

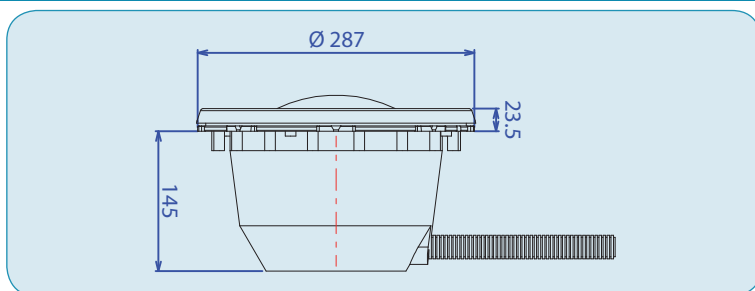

Code : 44400000 : 300W-12V, screwed.

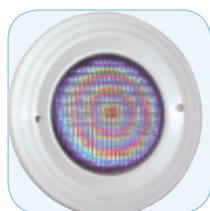

PL-06V-C

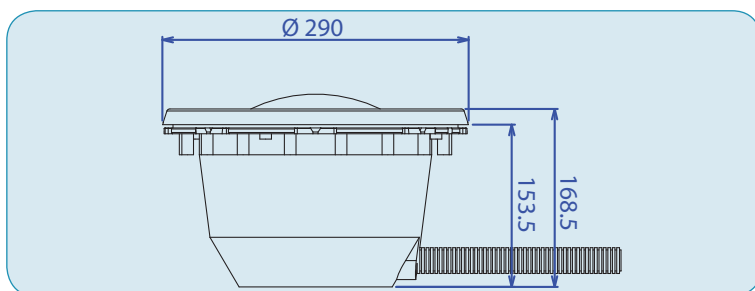

Code : 44405000 : 252 Colour LEDs, 12V, screwed.



PL-84C-C

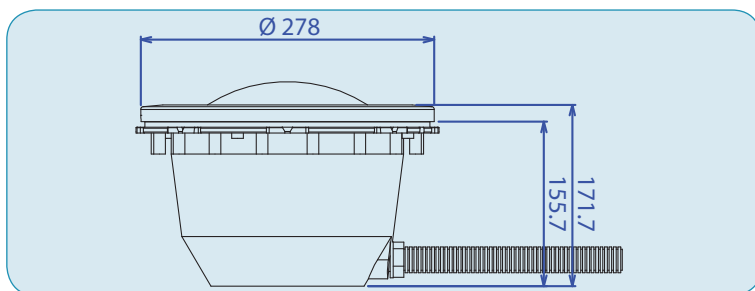

Code : 44420000 : 300W-12V, clipped.



PL-96B-C

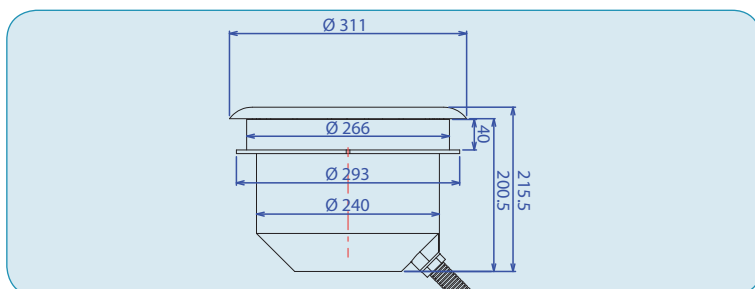

Code : 44430000 : Directional, 300W-12V.



PL-06B-C

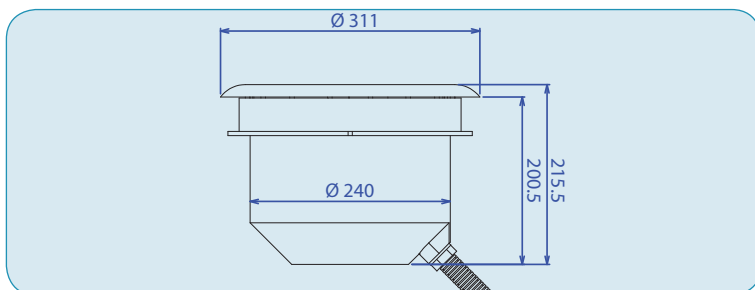

Code : 44435000 : 252 Colour LEDs, directional, 12V.



PH-05-100-C

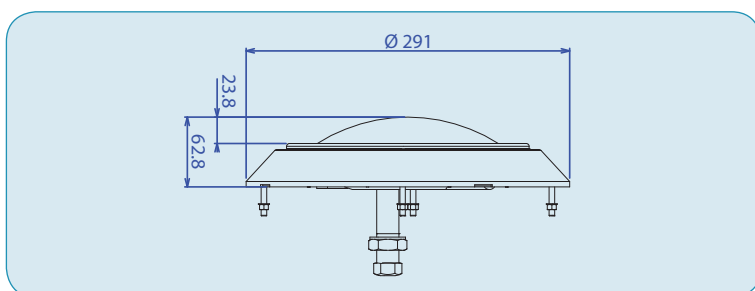

Code : 44451000 : Halogen extra flat, 100W-12V white PBC.

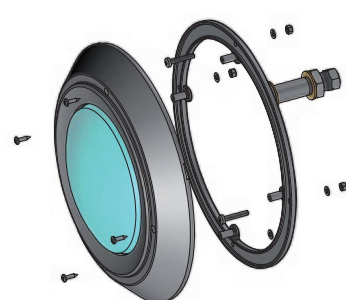
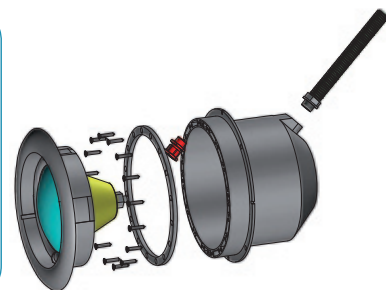
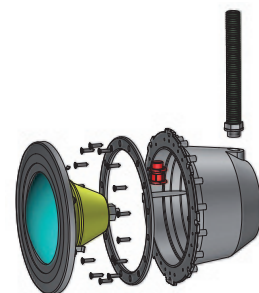
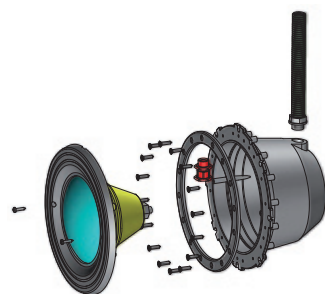
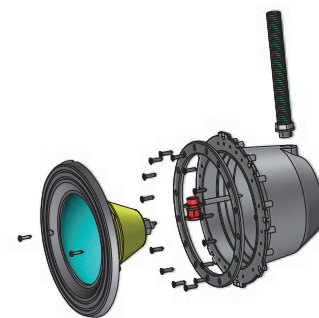

Wooden pool



PH-05-W

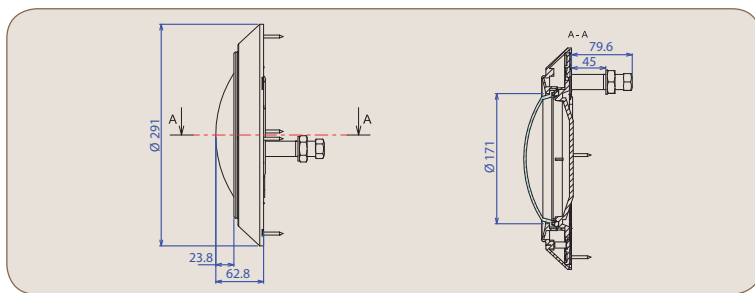

Code : 44370000 - Extra flat, 50W.

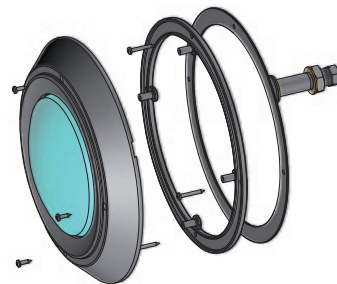

Deck boxes



BC-84-S / BC-84-G

Code : 45000500 - 2 outlets and 1 entrée, colours Beige or Grey.

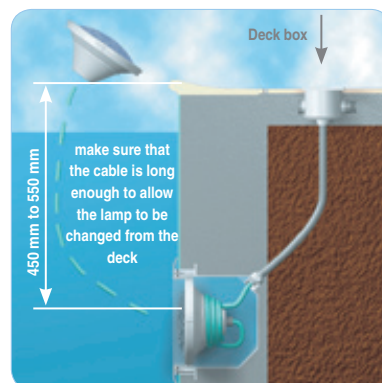

Face trims

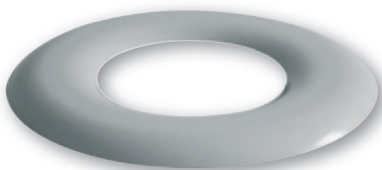

Face trim for PL-PB84

Code : 44900081 - Light blue
Code : 44900082 - Dark blue
Code : 44900084 - Caribbean green
Code : 44900085 - Beige
Code : 44900088 - Grey
Code : 44900087 - Anthracite grey
Code : 44900089 - Black

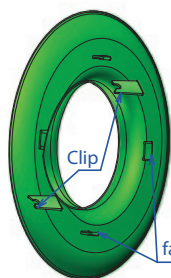
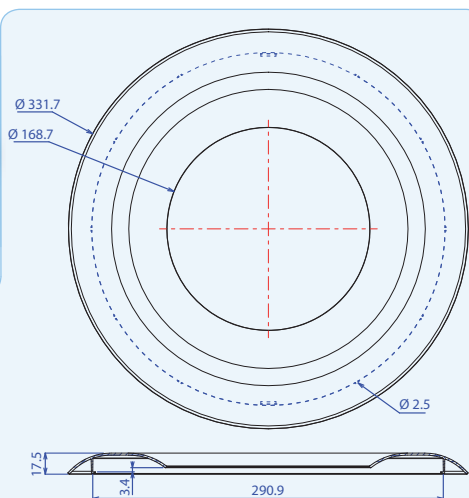

Face trim for PL-PB96

Code : 44930081 - Light blue
Code : 44930082 - Dark blue
Code : 44930084 - Caribbean green
Code : 44930085 - Beige
Code : 44930088 - Grey
Code : 44930087 - Anthracite grey
Code : 44930089 - Black

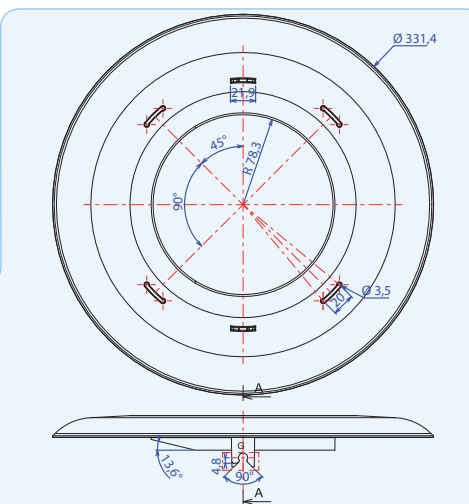

Aquareva Color

by PROCOPI



Underwater lights, PL-84V



Directional underwater lights, PL-96B



The underwater lights are also available in 7 colours as part of the Aquareva Color range; Light blue, Dark blue, Caribbean green, Beige, Grey, Anthracite grey and Black.

Choice and harmony throughout the range!

Exclusively from PROCOPI

Dealer's stamp